



## 22 Tickhill Way

Rossington, Doncaster, DN11 0FL

**Guide Price £390,000**

Guide Price £390,000 - £400,000. A fantastic opportunity to purchase a large style 4 bedroom detached family home. Offering generous accommodation on a sizeable plot and lying within easy reach of local shops, schools and motorway networks this property must be viewed. Comprising; hall with cloaks/wc, double doors to lounge with additional set of doors leading to separate dining room, kitchen/breakfast room, utility and home office. To the first floor there is the master bedroom and en-suite bathroom, 3 further double bedrooms with bedroom 3 having fitted wardrobes, and a 4 piece family bathroom. Outside to the front there is a driveway with parking for several cars and lawned garden leading to double garage. To the rear there is an enclosed garden with shed and patio along with mature trees offering privacy.

- Larger style 4 bedroom family home
- Study
- Separate utility
- kitchen/breakfast room
- Ensuite bathroom to master
- Ample parking for several cars
- Double garage
- Close to local schools
- No onward chain

### Viewing

Please contact our Office on 01302 751616 if you wish to arrange a viewing appointment for this property or require further information.

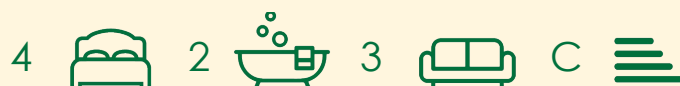



Floor Plan

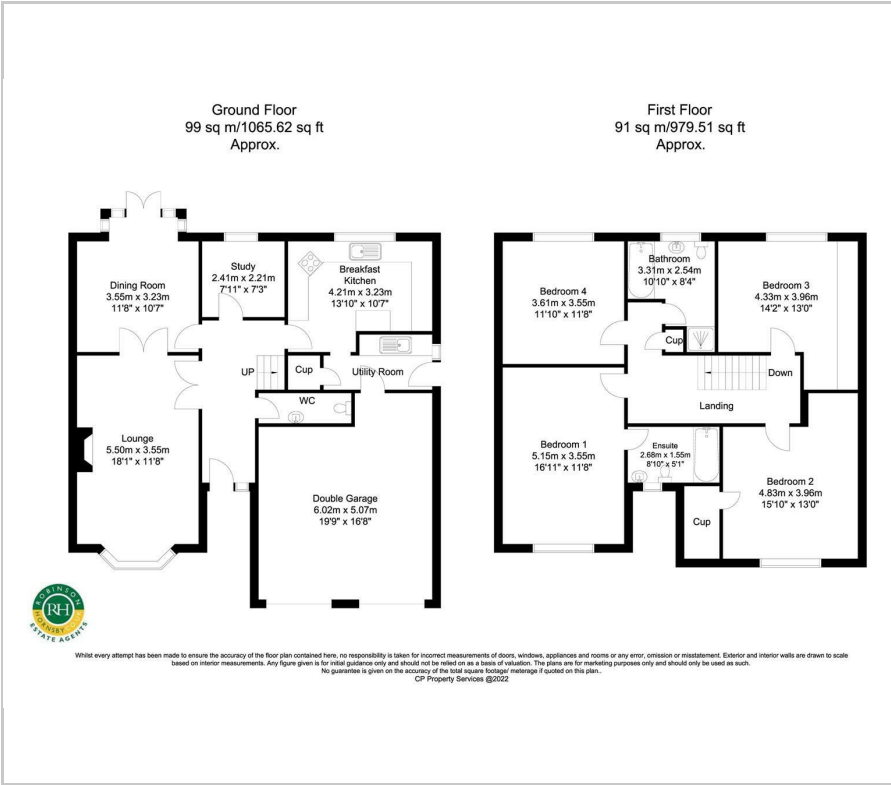

Area Map



Energy Efficiency Graph

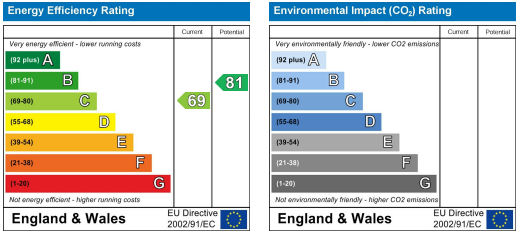

These particulars, whilst believed to be accurate are set out as a general outline only for guidance and do not constitute any part of an offer or contract. Intending purchasers should not rely on them as statements of representation of fact, but must satisfy themselves by inspection or otherwise as to their accuracy. No person in this firms employment has the authority to make or give any representation or warranty in respect of the property.